

INSTALLATION INSTRUCTIONS

SOAP DISPENSER

壁式擠皂器

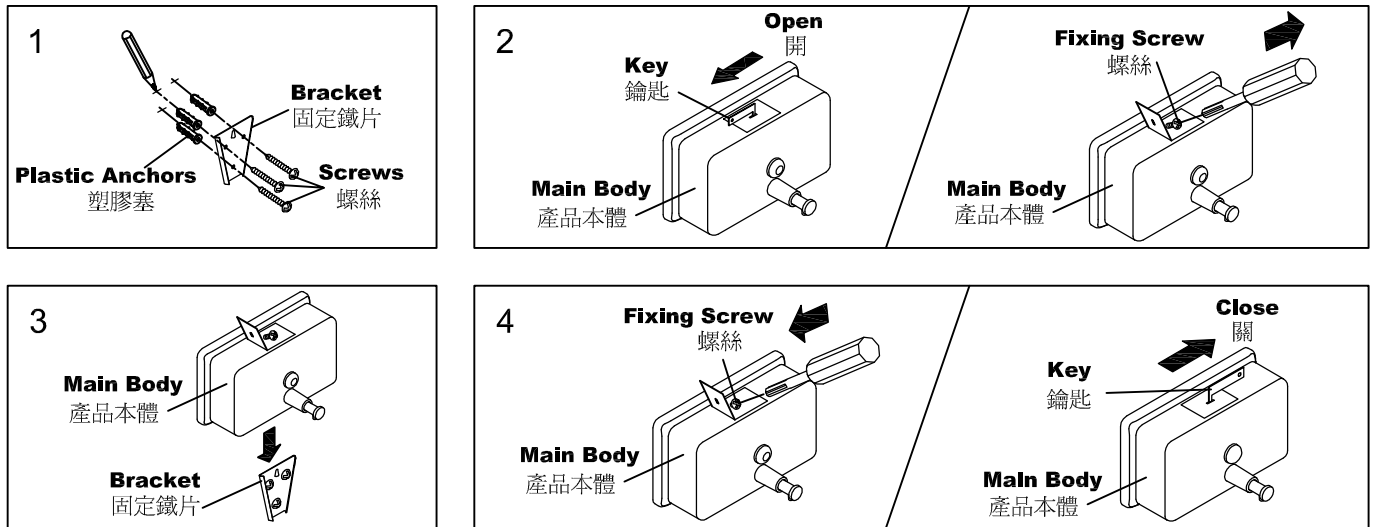

1. Use **Bracket** as template to locate appropriate drilling centers with pencil, use 6mm drilling bit to drill 4cm holes on your marked places, and please insert the **Plastic Anchors** while mounting on the dry wall, Fix the **Bracket** on the wall with **Screws** as fig.1 shown.

使用固定鐵片和鉛筆在預定鑽孔的位置,畫上記號,安裝水泥牆,使用1/4英寸(6mm)鑽頭,鑽孔深度4cm,嵌入塑膠塞使之齊平於牆面,將固定鐵片以螺絲鎖在牆面上,如圖1.

2. Pull the **key** provided from right to left direction to open the cover, and then loosen the **Fixing Screw** in the **Main Body** with screw driver if the **Fixing Screw** would interfere with the **Bracket** while mounting as fig. 2 shown.

用鑰匙將產品本體上蓋由右往左開啓,用螺絲起子將本體內部的螺絲放鬆,以避免安裝時與固定鐵片干涉.如圖2.

3. Slide the **Main Body** into the **Bracket** as fig.3 shown.

將產品本體由上往下裝入固定鐵片.如圖3.

4. Tighten **Fixing Screw** to the **Bracket** with screwdriver, and then pull the **Key** provided, in the direction from left to right, to close the cover as fig. 4 shown.

用螺絲起子將本體內部的螺絲鎖緊於固定鐵片,用鑰匙將產品本體上蓋由左往右關閉.如圖4.

Operation

使用方式

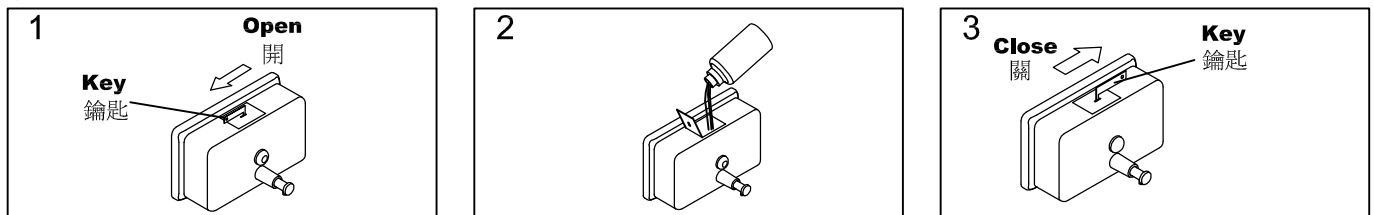

Pull the **Key** provided from right to left to open the cover as fig. 1 shown and fill **Main Body** with hand soap as fig. 2 shown.

Pull the **Key** provided from left to right to close the cover as fig. 3 shown.

用鑰匙將產品本體上蓋由右往左開啓如示圖1, 將洗手乳倒入產品本體如示圖2. 再用鑰匙將產品本體上蓋由左往右關閉如示圖3.

FIXING CONTENTS

組配件內容

