

Through-Glass Robe Hook 6880-5G-81CP

INTRODUCTION:

"Cylinder" began to become an indispensable design element of the building during the Renaissance. The 6880 series as a whole has injected classic European-style into bathroom products with accurate arc angles and geometric shapes.



DESCRIPTION:

- 1.Brass of mounting base and hook meet JIS 3604 standard.
- 2.Brass of forging bracket meets JIS 3771 standard.
- 3.Justime finishes resist corrosion and tarnish.
- 4.Chrome plated finish meets the standard of ASTM-SC2.
- 5.Vertical force could support a static load of 5 Kgf.
- 6.The robe hook is specially designed for the glass partition, it could provide more stability during the operation.
- 7.Coordinates with other products in 6880 collection.

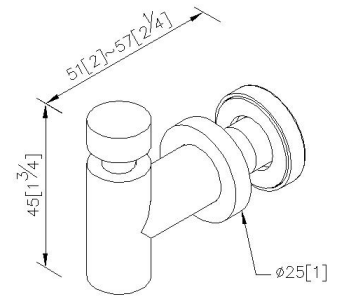

unit: mm[inch]

Certificaion:

Fixing Kits:

N/A

AWARD: