

## Single-Handle Concealed Valve (Upward Outlet) 6777-XF-80CP

### INTRODUCTION:

To create a comfortable bathroom space, we simplified the idea of its interior design. We would like to present a tidy, functional, but not monotone or narrow shower space for users.

Therefore, modern designers have come up a "concealed" conception with bath fittings. By removing the exposed metal pipes, the interior space can be increased a lot, making the bathroom more hygienic and natural. Eventually, taking a shower would be pleased, rather than just functional.



### DESCRIPTION:

1. The mixing valve could be installed in the cemented and wood wall.
2. The burying depth of embedded body is between 2"(6cm)Min~3"(7.6cm)Max from the finished wall.
3. Handle can be moved up to 22° to adjust water flow from closed position; hot and cold water controlled by swinging handle for 45° both right and left sides.
4. Ceramic valve Past 500,000 times lifespan test.
5. G1/2 inlet.
6. The faucet should be used at the water pressure from 1 to 6 kg/cm<sup>2</sup>.
7. Chrome plated finish meets the standard of ASTM-SC2.

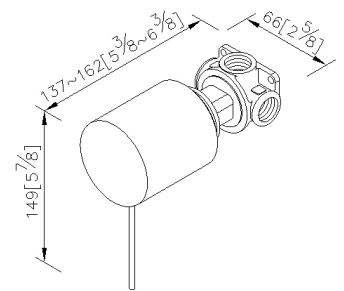

unit: mm[inch]

### Certification:

### Fixing Kits:

- 1.

### AWARD: