

## Shower Holder 6703-9C-80CP

### INTRODUCTION:

Classik Series Faucets created the classic style across generations with precise design and modern technologies for satisfying the fine art request of present generation.



### DESCRIPTION:

- 1.Brass of forging body meets JIS 3771 standard.
- 2.Premium metal construction for durability.
- 3.Justime finishes resist corrosion and tarnish.
- 4.Finish meets the standard of ASTM-SC2.
- 5.Coordinates with other products in Classik collection.

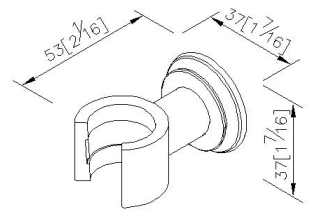

### Certification:

unit: mm[inch]

### Fixing Kits:

- SUS 304 Stainless Steel Screws\*2
- Hex Key 2.5mm\*1
- Plastic Anchors\*2

### AWARD: