

# INSTALLATION INSTRUCTIONS

## Kitchen Faucet W/ Sprayer 廚房龍頭 (附噴槍) 安裝說明

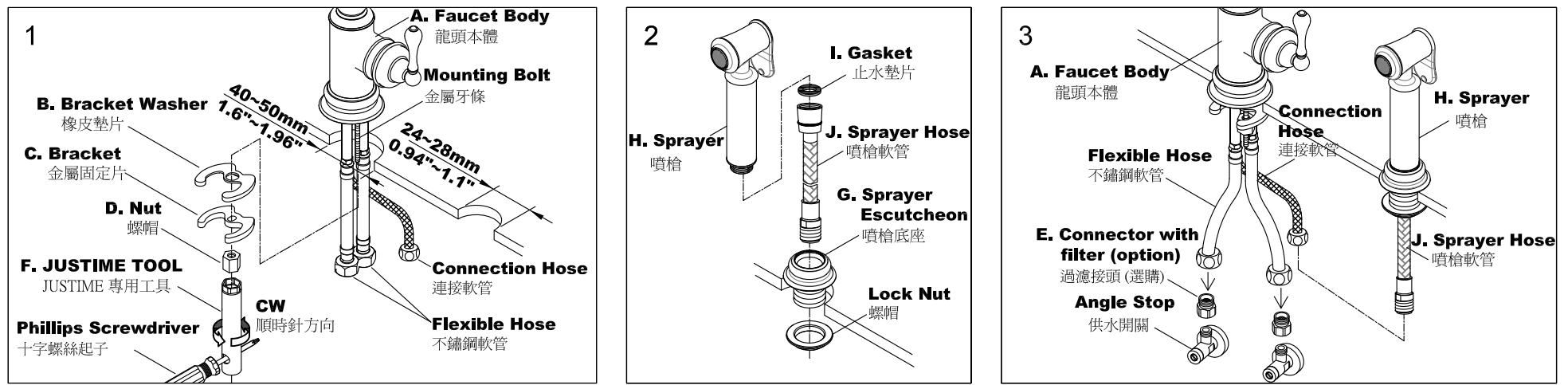

### CAUTION: Prevent The Risk Of Product Damage.

注意：為增加產品使用壽命，請依說明清潔供水管路。

a. Turn the angle stops (water suppliers) on and run for 1 minute before connecting supply hose (flexible hose) to faucet body. or b.

安裝編織管之前，先把供水開關全開排水一分鐘。或 b/

b. Connect and tighten the faucet and angle stops with supply hose (flexible hose) to finish installation, then remove the aerator, fully turn on both hot and cold water run for 1 minute; turn off the water and reinstall the aerator.

把龍頭、供水開關及編織管接好並鎖緊之後，把起泡器移開，把熱水及冷水全部轉開一分鐘，然後把水關掉再把起泡器裝回去。

1. Screw **Flexible Hoses** and **Mounting Bolt** into the bottom of **Faucet Body**, and then insert **Flexible Hoses** and **mounting bolt** through the hole in fixture. Position **Faucet Body** on fixture and place **Bracket with Bracket Washer** and **Nut** onto **Mounting Bolt**, and then tighten **Nut** securely.  
將冷熱進水不鏽鋼條軟管、連接軟管和金屬牙條穿過洗臉盆(檯)洞口後，從金屬牙條下方依序套入橡皮墊片、金屬固定片和螺帽，確認方向位置後，利用JUSTIME專用工具鎖緊螺帽固定龍頭即可。
2. Remove **Lock Nut** from **Sprayer Escutcheon**, insert **Sprayer Escutcheon** into the deck hole, and then tighten **Lock Nut** to fix **Sprayer Escutcheon** in right place.  
將噴槍底座上的螺帽鬆開，然後將噴槍底座穿過檯面洞口，鎖緊螺帽固定噴槍底座。
3. Connect **Sprayer** with **Sprayer Hose**, insert **Sprayer Hose** through **Sprayer Escutcheon** and then connect **Sprayer Hose** to **Connection Hose** securely. Connect Hot & Cold **Flexible Hoses** to angle stops.  
組合噴槍軟管與噴槍，並連結鎖緊噴槍軟管與連接軟管。最後連接冷熱進水不鏽鋼軟管到供水開關，確認完成安裝程序。

### MAINTAINING & CAUTION:

維護方式及注意事項:

1. To clean the plastic meshes cover: using 4mm **Hex Key** to remove the plastic meshes cover only as figure shown.  
清潔噴槍起泡器，如圖示，使用橡皮墊片逆時針旋轉拆卸噴槍起泡器蓋，取出起泡器及墊片，進行清洗或更換後，依拆卸相反順序組裝即可。
2. Do not remove inner metal seal. Reassemble the inner metal seal parts may cause sprayer out of function or damage to sprayer.  
請勿取出內部金屬止水零件。重新組裝內部金屬止水零件，可能導致噴槍功能失效或嚴重損壞噴槍。

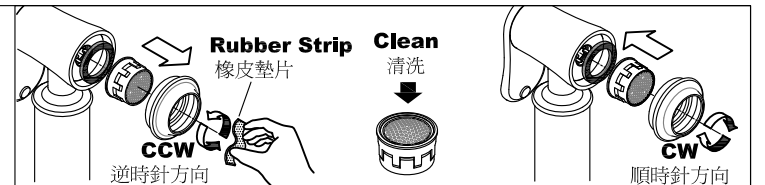

### Divert replacing guide

水流切換設備更換說明



4. Shut off the water supplies, and then disassemble **Nut**, **Bracket**, and **Bracket Washer** in sequence.  
在檯面底下從金屬牙條處，依序取下螺帽、金屬固定片、橡皮墊片。
5. Disassemble **Flexible Hoses**, **Connection Hose** and **Connector** from the bottom of **Faucet Body**.  
先從龍頭本體底部，取下不鏽鋼軟管，再取下連接軟管以及接頭。
6. Remove **Diverter** from **Connector** for cleaning or replacement, and then reassemble as the opposite steps of disassembling.  
從接頭取出切換設備，進行清洗或更換後，再依拆卸相反順序組裝即可。

### Check Valve replacing guide

逆止閥設備更換說明

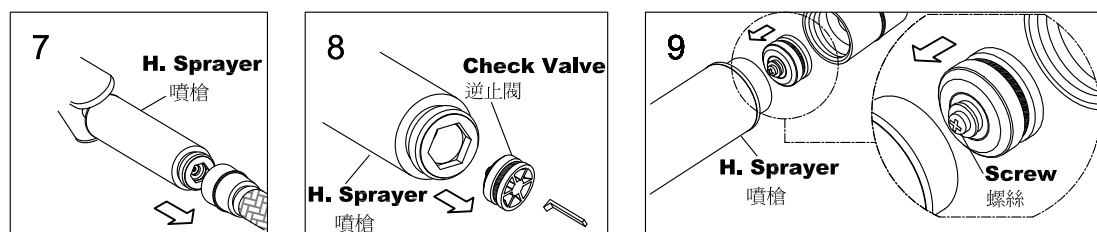

7. Disassemble **Sprayer Hose** from **Sprayer** as figure 7 show.  
如圖.7所示，將蛇管從噴槍拆下。
8. Take out **Check Valve** from the bottom of **Sprayer** as figure 8 show.  
如圖.8所示，將逆止閥從噴槍拆下。
9. After cleaning or replacing the **Check Valve**, restore **Check Valve** into **Sprayer** in the order as figure 9 show, and then connect **Sprayer Hose** to finish the replacement.  
將逆止閥裝回噴槍(螺絲端朝噴槍)並且將噴槍軟管鎖緊，如圖.9所示。

### FIXING CONTENTS

組配件內容

